

Soldered fittings

Piping technology
copper/gunmetal

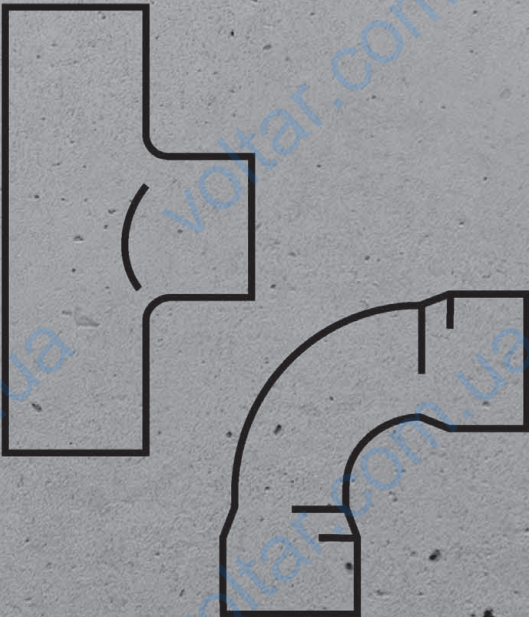

Fittings made of gunmetal in acc. with DVGW worksheet GW 6 and fittings made of copper in acc. with DVGW worksheet GW 8 for copper pipes in acc. with DVGW worksheet GW 392.

Certificates

- BHKS and ZVSHK liability transfer agreements for copper and gunmetal fittings as well as wall lead-ins made of gunmetal
- Fittings made of copper in acc. with DVGW-AB GW 8, DVGW-Reg.-No. DV-7411AO2955, quality seal RAL-RG 641/4
- Fittings made of gunmetal in acc. with DVGW-AB GW 6, DVGW-Reg.-No. DV-7401AO2956

Note

Elbow model 95090 and model 95092 do not conform to DVGW worksheet GW 8 and are not approved for use in gas and drinking water installations!

Marking

DVGW test mark
Quality seal RAL-RG 641/4



= Quality seal for d 12-54

Official quality seal



INDEX

Elbows	4
Elbows	6
T-pieces	6
Cross T-pieces	9
Adapter pieces/adaptor elbows	10
Couplings	12
Reductions	13
Screw fittings	14
Caps, plugs	17
Wall plates	18
Mounting units	19
Wall lead-ins	22



4 015211 305611

GTIN-Code (Global Trade Item Number, previously EAN-Code)

The GTIN-Code composed out of the constant manufacturer number 4015211 and a six-digit article code - in this example 305 611. The exchange of the last six digits against the article code shows the GTIN-Code.

ELBOWS

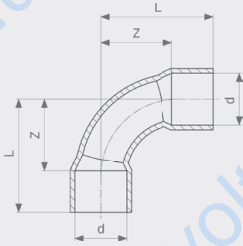

Elbow 90°
- copper
Model 95002A

article	Cu	d	Z	L
122 645		6	8	14
109 288		8	10	17
102 494		10	14	22
100 513	✓	12	14	23
467 463	✓	14	17	28
100 018	✓	15	18	29
467 470	✓	16	19	30
100 148	✓	18	19	32
100 063	✓	22	26	42
100 193	✓	28	32	52
101 046	✓	35	42	65
102 777	✓	42	50	77
104 115	✓	54	65	97
119 829		64.0	83	116
125 080		76.1	100	134
127 077		88.9	112	150
138 431		108.0	177	225

Cu = quality seal for d12-54

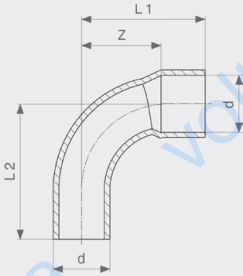

Elbow 90°
- copper
Model 95001A

article	Cu	d	Z	L1	L2
117 184		8	10	17	18
105 136		10	14	22	24
101 510	✓	12	14	23	25
465 742	✓	14	17	28	28
100 155	✓	15	18	29	31
467 456	✓	16	19	30	30
100 575	✓	18	22	35	37
100 391	✓	22	26	42	43
100 827	✓	28	34	53	55
103 415	✓	35	42	65	67
108 052	✓	42	50	77	79
112 028	✓	54	65	97	98
594 350		64.0	76	108	110
634 254		76.1	92	125	128
634 261		88.9	107	144	148

Cu = quality seal for d12-54

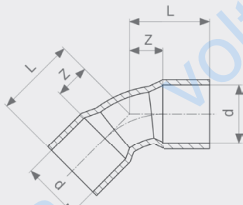

Elbow 45°
- copper
Model 95041

article	Cu	d	Z	L
110 420		10	6	14
103 309	✓	12	5	14
467 500	✓	14	6	17
100 483	✓	15	6	17
467 517	✓	16	7	18
101 077	✓	18	8	20
100 704	✓	22	9	25
101 459	✓	28	12	31
104 016	✓	35	14	38
108 823	✓	42	17	44
112 196	✓	54	22	54
138 394		64.0	37	70
144 043		76.1	33	67
144 425		88.9	40	78
158 071		108.0	62	110

Cu = quality seal for d12-54

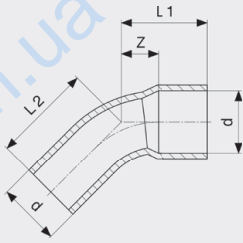

Elbow 45°
- copper
Model 95040

article	Cu	d	Z	L1	L2
109 325		10	6	14	16
103 019	✓	12	5	15	16
467 487	✓	14	6	17	17
100 292	✓	15	6	17	19
467 494	✓	16	7	18	18
100 773	✓	18	8	20	22
100 605	✓	22	9	25	27
101 336	✓	28	12	31	33
104 955	✓	35	14	38	40
110 338	✓	42	17	44	46
114 916	✓	54	22	54	56
594 244		64.0	32	64	66
633 837		76.1	38	71	74
633 844		88.9	44	82	85

Cu = quality seal for d12-54

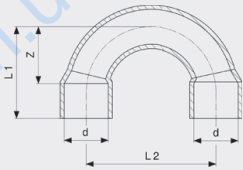

Elbow 180°
- copper
Model 95060

article	d	Z	L1	L2
117 542	10	16	24	30
121 785	12	17	26	34
115 951	15	22	34	45
113 445	18	26	39	52
121 518	22	32	48	66
128 029	28	41	60	84

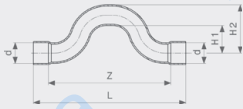

Crossover
- copper
Model 95085

article	Cu	d	Z	L	H1	H2
102 159	✓	15	90	112	20	35
104 672	✓	18	102	128	20	38
103 798	✓	22	115	147	23	45

Cu = quality seal for d12-54

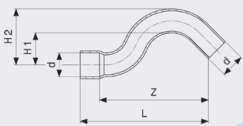

Crossover
- copper
Model 95086

article	Cu	d	Z	L	H1	H2
107 864	✓	12	66	76	20	32
102 012	✓	15	68	80	20	35
104 481	✓	18	73	87	20	38
105 396	✓	22	86	104	23	45

Cu = quality seal for d12-54

ELBOWS

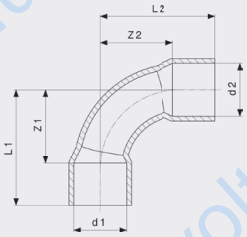

Elbow 90°
- copper
Model 95090

article	d1	d2	Z1	Z2	L1	L2
107 901	8	8	7	7	14	14
103 132	10	10	14	14	22	22
100 803	12	12	12	12	21	21
467 524	14	14	14	14	25	25
116 897	15	12	15	21	26	30
100 094	15	15	10	10	21	21
467 531	16	16	16	16	27	27
100 452	18	18	16	16	29	29
100 278	22	22	15	15	31	31
100 711	28	28	19	19	38	38
103 088	35	35	28	28	51	51
106 416	42	42	34	34	61	61
109 905	54	54	45	45	77	77
594 411	64.0	64.0	76	76	108	108
594 428	76.1	76.1	66	66	100	100
594 435	88.9	88.9	78	78	116	116
594 442	108.0	108.0	130	130	178	178

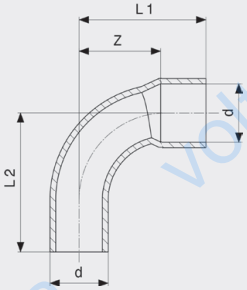

Elbow 90°
- copper
Model 95092

article	d	Z	L1	L2
113 773	8	11	18	18
108 700	10	14	22	24
102 920	12	12	21	25
467 548	14	14	25	25
100 414	15	12	23	25
467 555	16	16	27	27
101 169	18	16	28	30
100 933	22	18	34	37
102 067	28	25	44	46
107 079	35	28	51	55
113 995	42	34	61	65
118 891	54	45	77	81

T-PIECES

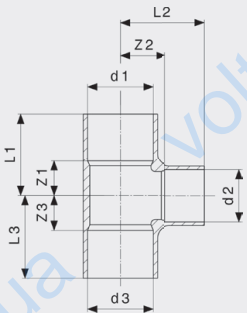

T-piece
- copper
Model 95130

article	Cu	d1	d2	d3	Z1	Z2	Z3	L1	L2	L3
107 475		6	6	6	5	4	5	11	10	11
128 968		8	6	8	6	7	6	13	13	13
105 747		8	8	8	6	5	6	13	12	13
120 009		10	6	10	4	6	4	13	13	13
104 092		10	10	10	6	6	6	14	14	14
136 635		12	8	12	7	9	7	16	16	16
109 745		12	10	12	7	8	7	16	16	16
101 435	✓	12	12	12	7	7	7	16	16	16
106 799*	✓	12	15	12	11	8	11	20	19	20

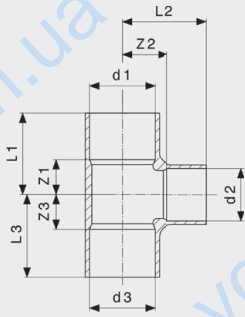

T-piece
- copper
Model 95130

article	Cu	d1	d2	d3	Z1	Z2	Z3	L1	L2	L3
584 412	✓	14	12	12	8	8	14	19	17	23
467 586	✓	14	12	14	8	8	8	18	17	18
584 429	✓	14	14	12	8	8	15	19	19	24
467 562	✓	14	14	14	8	8	8	18	19	18
584 436	✓	14	16	14	8	9	8	20	20	20
120 245		15	8	15	8	12	8	19	18	19
106 355		15	10	15	8	10	8	19	18	19
103 569	✓	15	12	12	8	10	14	19	20	23
101 848	✓	15	12	15	8	10	8	19	20	19
104 863	✓	15	15	12	8	9	15	19	20	24
100 131	✓	15	15	15	8	9	8	19	20	19
103 200	✓	15	18	15	13	10	13	24	23	24
105 143	✓	15	22	15	16	13	16	27	29	27
584 443	✓	16	12	14	8	9	14	19	18	25
467 593	✓	16	12	16	8	9	8	19	18	19
584 962	✓	16	14	12	8	9	16	19	20	25
584 955	✓	16	14	14	8	9	13	19	20	24
467 609	✓	16	14	16	8	9	8	18	20	18
467 579	✓	16	16	16	8	9	8	20	20	20
584 979	✓	16	18	14	13	11	16	24	24	27
584 986	✓	16	18	16	13	11	13	24	24	24
120 122	✓	18	12	12	8	13	8	21	22	25
107 413	✓	18	12	15	8	13	14	21	22	25
103 606	✓	18	12	18	8	13	8	21	22	21
584 993	✓	18	14	14	8	10	14	21	21	25
585 006	✓	18	14	16	8	10	14	21	21	25
467 616	✓	18	14	18	8	10	8	20	21	20
101 053	✓	18	15	15	8	13	14	21	24	25
100 582	✓	18	15	18	8	13	8	21	24	21
585 013	✓	18	16	14	8	10	14	21	21	25
585 020	✓	18	16	16	8	10	14	21	21	25
467 623	✓	18	16	18	8	10	8	22	21	22
114 565	✓	18	18	12	10	10	18	23	23	27
585 037	✓	18	18	14	10	10	16	23	23	27
102 890	✓	18	18	15	10	10	16	23	23	27
585 044	✓	18	18	16	10	10	16	23	23	27
100 612	✓	18	18	18	10	11	10	23	24	23
104 689	✓	18	22	18	14	13	14	28	29	28
104 733	✓	22	12	22	8	15	8	24	24	24
592 585	✓	22	14	18						
467 630	✓	22	14	22	8	12	8	24	23	24
101 725	✓	22	15	15	8	12	17	24	23	28
102 944	✓	22	15	18	8	12	7	24	23	28
100 445	✓	22	15	22	8	12	8	24	23	24
585 051	✓	22	16	16	8	12	18	24	23	28
585 068	✓	22	16	18	8	12	16	24	23	28
467 647	✓	22	16	22	10	12	10	26	23	26
105 297	✓	22	18	15	11	14	11	27	27	32
585 075	✓	22	18	16	11	14	21	27	27	32
103 217	✓	22	18	18	11	14	19	27	27	32
101 497	✓	22	18	22	11	14	11	27	27	27
585 082	✓	22	22	14	12	12	22	28	28	33
102 456	✓	22	22	15	12	12	22	28	28	33
585 099	✓	22	22	16	12	12	22	28	28	33
104 702	✓	22	22	18	12	12	20	28	28	33
100 476	✓	22	22	22	12	12	12	28	28	28
105 204	✓	22	28	22	20	14	20	36	34	36
114 183	✓	28	12	28	10	20	10	29	28	29

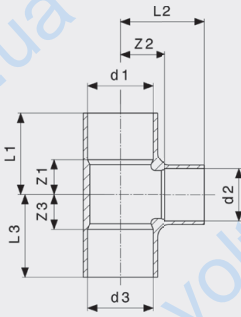

T-piece
- copper
Model 95130

article	Cu	d1	d2	d3	Z1	Z2	Z3	L1	L2	L3
106 737	✓	28	15	22	11	18	20	30	28	36
101 619	✓	28	15	28	10	18	10	29	28	29
114 947	✓	28	18	18	12	18	24	31	30	37
109 219	✓	28	18	22	12	18	21	31	30	37
102 852	✓	28	18	28	10	18	10	29	30	29
112 943	✓	28	22	15	12	18	26	31	34	37
122 119	✓	28	22	18	12	18	24	31	34	37
103 248	✓	28	22	22	12	18	21	31	34	37
101 282	✓	28	22	28	12	18	12	31	34	31
109 424	✓	28	28	15	15	16	29	34	34	40
113 032	✓	28	28	18	15	16	27	34	36	40
106 232	✓	28	28	22	15	16	24	34	34	40
101 022	✓	28	28	28	15	16	15	34	34	34
115 760	✓	28	35	28	20	18	20	39	41	39
107 291	✓	35	15	35	10	24	10	33	35	33
109 899	✓	35	18	35	11	23	11	34	36	34
123 673	✓	35	22	22	14	21	28	38	37	44
113 599	✓	35	22	28	14	21	26	38	37	44
104 375	✓	35	22	35	12	21	12	36	37	36
122 676	✓	35	28	22	23	19	16	41	42	49
110 727	✓	35	28	28	18	22	28	41	42	46
105 808	✓	35	28	35	16	22	16	39	42	39
121 235	✓	35	35	22	21	22	35	44	45	51
117 580	✓	35	35	28	21	22	32	44	45	51
104 184	✓	35	35	35	19	22	19	42	44	42
118 556	✓	42	15	42	13	28	13	40	39	40
125 479	✓	42	18	42	14	26	14	42	39	42
111 595	✓	42	22	42	16	26	16	43	42	43
110 383	✓	42	28	42	18	26	18	45	45	45
122 591	✓	42	35	35	23	26	34	50	49	57
113 711	✓	42	35	42	23	26	23	50	49	50
108 236	✓	42	42	42	26	25	26	52	52	52
118 792	✓	54	22	54	18	33	18	50	49	50
117 467	✓	54	28	54	18	34	18	50	53	50
117 818	✓	54	35	54	25	33	25	57	56	57
119 652	✓	54	42	54	26	34	26	58	61	58
110 819	✓	54	54	54	32	33	32	64	65	64
595 227		64.0	42	64.0	28	42	28	55	64	55
595 234		64.0	54	64.0	31	37	31	64	69	64
131 722		64.0	64.0	64.0	36	36	36	68	68	68
595 357		76.1	54	76.1	29	42	29	63	74	63
595 364		76.1	64.0	76.1	28	55	28	67	76	67
135 911		76.1	76.1	76.1	41	46	41	75	80	75
634 292		88.9	54	88.9	33	47	33	71	79	71
595 241		88.9	64.0	88.9	38	48	38	76	81	76
595 371		88.9	76.1	88.9	44	44	44	81	83	81
137 021		88.9	88.9	88.9	60	60	60	99	99	99
151 003		108.0	108.0	108.0	60	60	60	107	107	107

Cu = quality seal for d12-54

* = Discontinued, limited availability

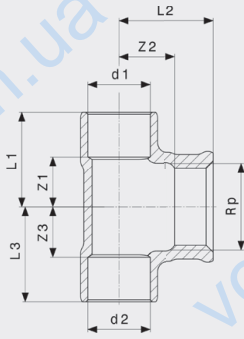

T-piece
- gunmetal
Model 94130G

article	d1	Rp	d2	Z1	Z2	Z3	L1	L2	L3
150 600	12	1/2	12	13	7	13	22	22	22
475 772	14	1/2	14	12	8	12	23	23	23
131 029	15	3/8	15	10	6	10	21	18	21
102 401	15	1/2	15	12	8	12	23	23	23
475 789	16	1/2	16	12	10	12	23	24	23
140 823	18	3/8	18	10	7	10	23	18	23
103 767	18	1/2	18	12	8	12	24	23	24
157 999	18	3/4	18	17	9	17	30	25	30
119 195	22	3/8	22	11	9	11	26	20	26
101 978	22	1/2	22	11	10	11	26	25	26
109 141	22	3/4	22	17	10	17	32	26	32
103 453	28	1/2	28	14	14	14	32	28	32
112 035	28	3/4	28	15	15	15	34	31	34
258 955	28	1	28	20	13	20	39	32	39
152 734	35	1/2	35	13	12	13	36	27	36
123 390	35	3/4	35	15	12	15	38	28	38
136 734	35	1 1/4	35	26	24	26	49	45	49
157 678	42	1 1/2	42	26	16	26	53	37	53

CROSS T-PIECES

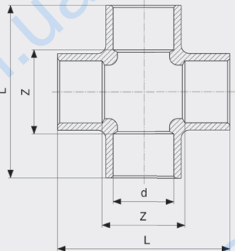

Cross piece
- gunmetal
Model 94180

article	d	Z	L
138 851	15	20	42
134 464	18	24	50
121 884	22	27	58
135 508	28	34	71

ADAPTER PIECES/ADAPTER ELBOWS

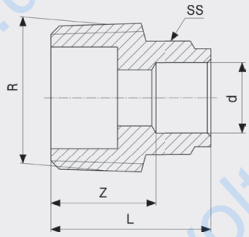

Adapter
- gunmetal
Model 94243G

article	d	R	Z	L	SS
151 614	8	¼	12	19	17
145 002	8	¾	12	20	12
136 673	10	¼	11	20	14
114 060	10	¾	11	19	12
112 400	10	½	15	23	14
132 620	12	¼	12	21	16
101 152	12	¾	12	21	16
101 398	12	½	14	22	16
467 746	14	¾	14	25	18
467 739	14	½	14	25	18
101 657	15	¾	13	24	19
100 025	15	½	15	26	18
102 234	15	¾	16	27	19
467 753	16	½	14	26	20
467 760	16	¾	15	26	20
100 650	18	½	15	28	21
101 039	18	¾	13	26	21
101 749	22	½	17	33	26
100 322	22	¾	16	32	26
100 889	22	1	16	32	26
121 228	28	½	18	37	32
102 913	28	¾	18	37	32
100 285	28	1	18	37	32
105 839	28	1¼	19	40	32
107 109	35	1	22	45	39
102 661	35	1¼	21	44	42
174 484	35	1½	12	35	42
141 905	42	1¼	26	53	48
106 638	42	1½	21	48	48
258 481	42	2	15	42	48
169 305	54	1½	28	60	61
109 196	54	2	30	62	61
138 202	64.0	2½	24	57	71
137 236	76.1	2½	34	68	83
140 007	88.9	3	41	79	97
159 634	108.0	4	48	96	119

SS = spanner size

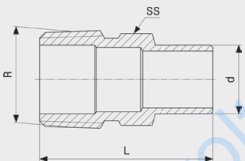

Adapter
- gunmetal
Model 94280G

article	d	R	L	SS
116 040	15	½	38	18
120 221	18	½	40	20
131 166	22	½	44	24
117 894	22	¾	44	25
126 940	28	1	51	30
140 946	35	1¼	60	40
142 841	42	1½	61	48

SS = spanner size

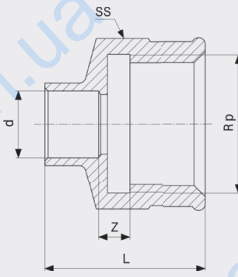

Adapter
- gunmetal
Model 94270G

article	d	Rp	Z	L	SS
118 976	10	¼	1	20	16
118 051	10	¾	1	21	20
119 515	10	½	1	24	25
105 259	12	¾	2	22	20
104 214	12	½	1	25	25
475 758	14	½	2	28	25
101 787	15	¾	2	24	20
100 254	15	½	2	28	25
104 771	15	¾	2	29	30
475 765	16	½	2	28	25
100 940	18	½	2	30	25
102 180	18	¾	2	31	30
101 664	22	½	2	33	25
100 728	22	¾	1	34	30
102 470	22	1	1	36	38
104 139	28	¾	2	37	30
100 964	28	1	2	40	38
107 192	28	1¼	4	44	47
165 864	35	¾	0	40	34
107 857	35	1	1	43	40
108 267	35	1¼	6	50	48
163 419	42	1¼	6	54	49
117 597	42	1½	4	52	53
160 586	54	2	3	61	66
144 418	64.0	2½	4	66	83

SS = spanner size

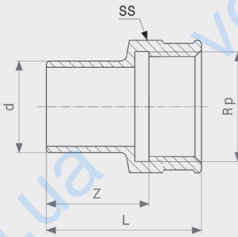

Plug-in piece
- gunmetal
Model 94246G

article	d	Rp	Z	L	SS
117 917	12	¾	14	26	20
119 669	12	½	17	32	26
467 784*	14	½	15	30	25
118 549	15	¾	16	27	20
106 553	15	½	16	32	25
111 274	18	½	18	33	25
132 873	18	¾	20	36	31
112 455	22	½	21	36	25
118 846	22	¾	21	38	30
131 838	28	¾	24	40	30
117 849	28	1	25	44	38
133 252	35	1¼	37	58	49

SS = spanner size

* = Discontinued, limited availability

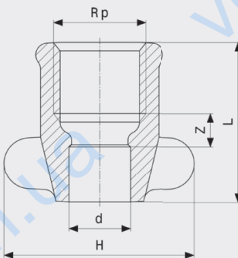

Adapter
- gunmetal
Model 94270GF

article	d	Rp	Z	L	H
103 880	15	½	6	32	40

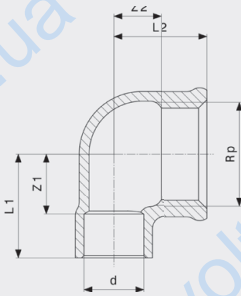

Adapter elbow 90°
- gunmetal
Model 94090G

article	d	Rp	Z1	Z2	L1	L2
117 887	12	3/8	11	5	20	16
105 693	12	1/2	12	4	21	19
467 692	14	1/2	13	12	24	22
148 362	15	3/8	10	6	21	18
100 667	15	1/2	12	6	22	22
130 114	15	3/4	17	7	28	23
467 708	16	1/2	13	12	24	22
104 436	18	1/2	12	8	24	23
109 011	18	3/4	16	8	28	24
106 102	22	1/2	11	8	27	23
107 581	22	3/4	16	10	32	26
113 865	22	1	19	11	35	30
144 203	28	3/4	15	14	34	30
109 561	28	1	21	13	40	32
173 494	35	1 1/4	23	19	46	40
166 397	42	1 1/2	26	24	53	45
151 676	54	2	32	29	64	55

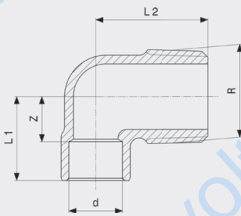

Adapter elbow 90°
- gunmetal
Model 94092G

article	d	R	Z	L1	L2
103 910	12	3/8	9	18	22
108 687	12	1/2	10	19	26
467 715	14	1/2	12	23	29
106 577	15	3/8	10	21	26
100 568	15	1/2	10	20	28
467 722	16	1/2	12	23	29
107 635	18	1/2	18	32	30
133 108	18	3/4	14	26	31
136 307	22	1/2	11	27	33
107 208	22	3/4	14	29	33
144 067	22	1	17	32	39
131 739	28	3/4	18	33	38
149 970	28	1	19	38	46
138 691	35	1 1/4	22	45	44

COUPLINGS

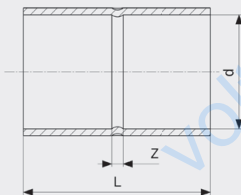

Coupling
- copper
Model 95270

article	Cu	d	Z	L
108 717		6	1	13
107 093		8	1	15
102 357		10	1	17
100 872	✓	12	2	19
467 654	✓	14	2	23
100 117	✓	15	2	23
467 661	✓	16	2	23
100 469	✓	18	2	27
100 353	✓	22	2	32
100 698	✓	28	2	38
102 616	✓	35	2	48
105 433	✓	42	2	56
106 744	✓	54	2	66
124 038		64.0	5	70
127 862		76.1	4	72
128 319		88.9	5	80
146 481		108.0	4	100

Cu = quality seal for d12-54

REDUCTIONS

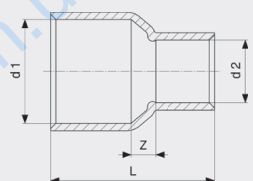

Reducing coupling
- copper
Model 95240

article	Cu	d1	d2	Z	L
142 872		8	6	4	17
121 082		10	6	2	16
121 150		10	8	2	18
120 504		12	8	5	24
107 420		12	10	4	20
585 136		14	10	4	23
464 301	✓	14	12	4	23
110 154		15	10	5	23
102 524	✓	15	12	5	26
464 318	✓	16	12	6	25
464 325	✓	16	14	4	25
106 874	✓	18	12	6	29
464 332	✓	18	14	6	29
101 176	✓	18	15	4	27
464 349	✓	18	16	4	27
110 758	✓	22	12	9	36
464 356	✓	22	14	8	34
101 565	✓	22	15	7	37
464 363	✓	22	16	7	33
101 602	✓	22	18	6	34
105 037	✓	28	15	12	44
585 143	✓	28	16	8	38
106 256	✓	28	18	7	42
102 111	✓	28	22	5	43
109 738	✓	35	22	11	50
105 334	✓	35	28	9	52
121 280	✓	42	22	23	66
117 269	✓	42	28	12	59
111 687	✓	42	35	10	60
124 076	✓	54	28	24	77
120 788	✓	54	35	14	69
116 118	✓	54	42	11	70
594 374		64.0	54	12	77
634 278		76.1	54	24	90
594 381		76.1	64.0	14	80
594 398		88.9	76.1	15	86
594 404		108.0	88.9	20	105

Cu = quality seal for d12-54

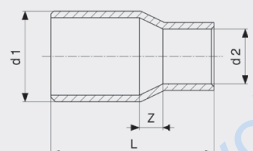

Reducer
- copper
Model 95243

article	Cu	d1	d2	Z	L
124 540		10a	6	2	18
119 805		10a	8	1	19
123 796		12a	6	3	24
116 187		12a	8	3	23
104 290		12a	10	1	19
465 674	✓	14a	12	2	22
105 983		15a	10	6	26
101 060	✓	15a	12	3	24
465 681	✓	16a	12	2	22
465 698	✓	16a	14	3	25
104 566	✓	18a	12	4	27
465 704	✓	18a	14	3	27
100 520	✓	18a	15	4	29
465 711	✓	18a	16	3	27
108 298	✓	22a	12	7	33
465 728	✓	22a	14	6	33
100 841	✓	22a	15	6	37
465 735	✓	22a	16	6	33
100 780	✓	22a	18	5	35
118 013	✓	28a	12	10	39
585 112	✓	28a	14	9	39
103 156	✓	28a	15	8	39

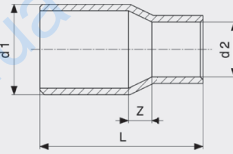

Reducer
- copper
Model 95243

article	Cu	d1	d2	Z	L
585 129	✓	28a	16	9	39
103 637	✓	28a	18	6	39
101 015	✓	28a	22	6	42
115 296	✓	35a	15	18	54
115 180	✓	35a	18	16	54
105 792	✓	35a	22	10	53
103 118	✓	35a	28	8	52
133 313	✓	42a	15	22	62
116 392	✓	42a	22	14	60
110 260	✓	42a	28	9	56
106 935	✓	42a	35	5	57
118 648	✓	54a	28	25	78
115 852	✓	54a	35	14	73
112 530	✓	54a	42	8	69
594 169		64.0a	35	21	78
594 176		64.0a	42	17	79
126 261		64.0a	54	6	75
594 190		76.1a	35	26	86
594 183		76.1a	42	23	86
127 732		76.1a	54	12	82
594 206		76.1a	64.0	10	79
634 308		88.9a	54	22	96
594 237		88.9a	64.0	18	92
132 866		88.9a	76.1	12	87
594 213		108.0a	64.0	27	111
594 220		108.0a	76.1	22	107
150 709		108.0a	88.9	15	103

Cu = quality seal for d12-54

SCREW FITTINGS

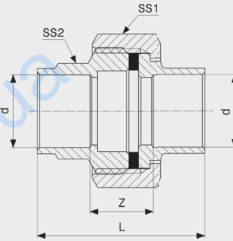

Screw fitting
- gunmetal
Model 94330

article	d	Z	L	SS1	SS2
110 239	15	13	35	29	19
122 249	18	14	40	29	22
116 583	22	14	45	36	26
154 196	28	18	55	46	32
176 174	35	22	68	52	40

SS = spanner size

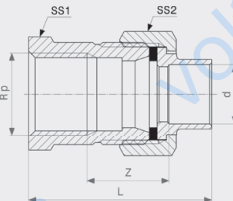

Adapter union
- gunmetal/brass
Model 94330G

article	d	Rp	Z	L	SS1	SS2
113 421	15	1/2	21	47	29	27
120 856	18	1/2	22	50	29	27
117 399	22	3/4	22	54	36	34
119 478	28	1	21	59	46	44

SS = spanner size

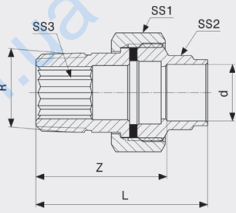

Adapter union
- gunmetal/brass
Model 94331G

article	d	R	Z	L	SS1	SS2	SS3
109 806	15	1/2	35	46	29	19	12
120 146	18	1/2	35	48	29	22	12
112 967	22	3/4	38	54	36	26	17
133 535	28	1	44	63	46	32	22
220 839	35	1 1/4	51	74	52	35	

SS = spanner size

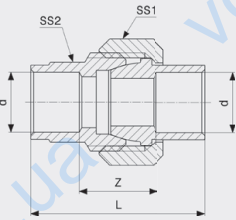

Screw fitting
- gunmetal
Model 94340

article	d	Z	L	SS1	SS2
132 033	10	13	30	18	12
151 645	12	12	30	23	16
103 699	15	13	35	29	19
124 434	18	14	40	29	22
104 399	22	13	45	36	26
107 604	28	16	54	46	32
114 695	35	20	66	52	40
125 899	42	21	76	58	49
148 256	54	27	91	74	61

SS = spanner size

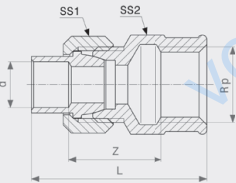

Adapter union
Model 94340G

article	d	Rp	Z	L	SS1	SS2
163 051	12	1/2	17	41	23	25
122 683	15	3/8	15	38	29	22
103 422	15	1/2	21	47	29	27
110 390	15	3/4	20	47	29	30
106 690	18	1/2	21	49	29	27
109 295	18	3/4	20	49	29	30
101 527	22	3/4	21	53	36	34
105 310	22	1	23	58	36	40
103 002	28	1	20	58	46	44
107 918	35	1 1/4	25	70	52	50
115 937	42	1 1/2	23	72	58	55
125 325	54	2	22	81	74	66

SS = spanner size

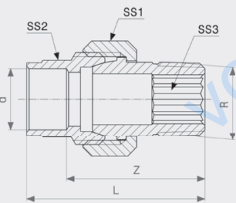

Adapter union
Model 94341G

article	d	R	Z	L	SS1	SS2	SS3
118 921	12	3/8	29	38	23	16	8
147 099	12	1/2	36	45	29	16	12
115 883	15	3/8	31	42	23	18	8
102 128	15	1/2	33	44	29	19	12
122 959	15	3/4	39	50	36	18	17
109 042	18	1/2	34	47	29	22	12
109 547	18	3/4	38	51	36	22	17
101 558	22	3/4	36	52	36	26	17
109 080	22	1	44	59	46	26	22
103 705	28	1	41	60	46	32	22
108 427	35	1 1/4	45	68	52	40	
118 327	42	1 1/2	50	78	58	49	
129 620	54	2	54	86	74	61	

SS = spanner size

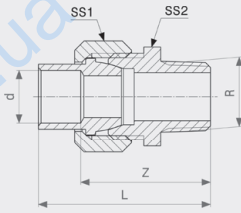

Adapter union
- gunmetal
Model 94343G

article	d	R	Z	L	SS1	SS2
167 202	12	3/8	29	38	23	22
134 716	12	1/2	33	42	22	23
102 395	15	1/2	35	46	29	27
120 771	15	3/4	39	50	29	28
111 984	18	1/2	35	48	29	27
116 859	18	3/4	39	52	29	28
102 685	22	3/4	40	55	36	34
115 098	22	1	41	57	36	34
103 996	28	1	44	63	46	44
110 581	35	1 1/4	52	75	52	50
115 135	42	1 1/2	54	82	58	55
119 980	54	2	65	97	74	71
144 005	64.0	2 1/2	78	110	93	90
165 918	76.1	2 1/2	76	110	102	98

SS = spanner size

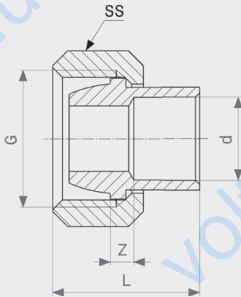

Connection screw fitting
- gunmetal
Model 94384G

article	d	G	Z	L	SS
136 666	12	1/2	2	19	23
113 148	15	3/4	2	23	29
130 367	18	3/4	2	25	29
116 323	22	1	2	28	36
125 998	28	1 1/4	2	32	46
130 794	35	1 1/2	5	40	52
138 745	42	1 3/4	4	44	58
140 366	54	2 3/8	6	51	74

SS = spanner size

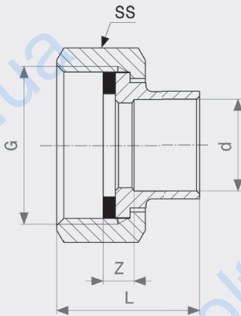

Connection screw fitting
Model 94359

article	d	G	Z	L	SS
288 402	15	3/4	5	24	29
288 396	18	3/4	6	27	29
288 389	22	1	5	29	36
288 372	28	1 1/4	6	34	46
288 365	35	1 1/2	10	42	52
288 358	42	1 3/4	7	44	58
288 341	54	2 3/8	9	50	74

SS = spanner size

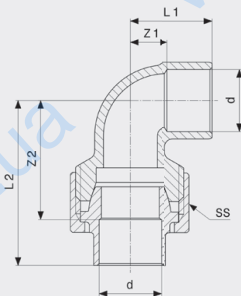

Adapter union
- gunmetal
Model 94096

article	d	Z1	Z2	L1	L2	SS
123 499	15	9	30	20	41	29
134 815	18	12	32	25	44	29
133 276	22	14	36	30	52	36
146 368	28	18	42	37	60	46

SS = spanner size

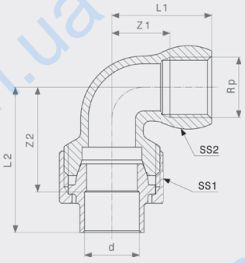

**Adapter union
Model 94096G**

article	d	Rp	Z1	Z2	L1	L2	SS1	SS2
114 787	15	1/2	18	31	33	42	29	28
119 461	18	1/2	21	31	33	44	29	28
216 962	18	3/4	23	39	39	52	36	33
107 338	22	3/4	23	37	39	53	36	33
120 498	22	1	25	40	44	56	36	40
112 295	28	1	28	44	47	63	46	39
121 433	35	1 1/4	35	50	56	73	52	48

SS = spanner size

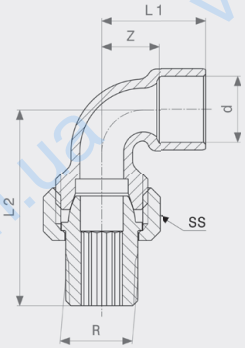

**Adapter union
Model 94098G**

article	d	R	Z	L1	L2	SS
120 979	12	1/2	9	18	49	29
103 859	15	1/2	9	20	49	29
110 017	18	1/2	12	25	51	29
120 580	18	3/4	12	25	59	36
114 909	22	3/4	14	30	59	36
144 128	28	1	18	37	68	46
120 061	35	1 1/4	22	45	76	52
144 098	42	1 1/2	24	51	85	59
146 450	54	2	28	60	100	74

SS = spanner size

CAPS, PLUGS

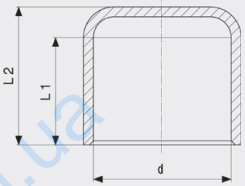

**Cap
- copper
Model 95301**

article	d	L1	L2
121 273	8	7	9
108 892	10	8	10
104 450	12	9	11
467 678	14	11	13
101 466	15	11	13
467 685	16	11	13
103 590	18	13	15
102 951	22	15	18
105 662	28	18	21
109 134	35	24	29
113 155	42	27	33
114 077	54	32	37
594 367	64.0	32	37

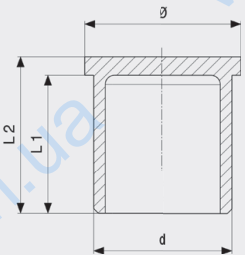

**Plug
- copper
Model 95290**

article	d	L1	L2	Ø
118 945*	15	15	17	17

Ø = diameter

* = Discontinued, limited availability

WALL PLATES

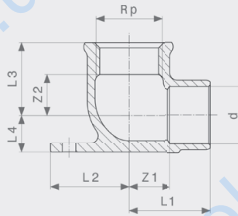

Wall plate
- gunmetal
Model 94471G

article	d	Rp	Z1	Z2	L1	L2	L3	L4
103 958	12	1/2	13	5	22	25	20	9
101 275	15	1/2	13	6	24	25	22	10
106 393	18	1/2	13	8	26	25	23	12
113 216	18	3/4	16	8	29	30	24	12
110 192	22	1/2	15	8	30	21	23	15
111 304	22	3/4	17	10	32	21	26	15
151 812	28	1	19	15	37	34	34	18

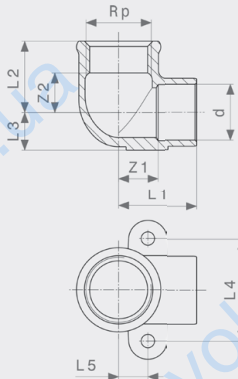

Wall plate
- gunmetal
Model 94472G

article	d	Rp	Z1	Z2	L1	L2	L3	L4	L5
103 965	12	1/2	13	5	22	20	9	33	9
467 791	14	1/2							
112 813	15	3/8	10	6	21	18	11	34	
100 223	15	1/2	12	6	22	22	10	33	9
467 807	16	1/2							
102 210	18	1/2	13	8	26	23	12	33	9
113 490	22	3/4	17	10	32	26	14	42	12

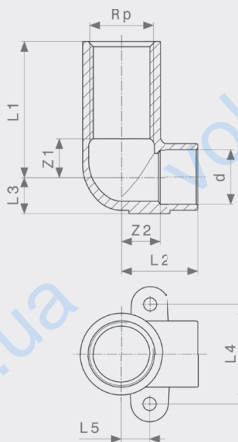

Wall plate
- gunmetal
Model 94472GL

article	d	Rp	L	Z1	Z2	L1	L2	L3	L4	L5
105 129	15	1/2	45	12	13	45	24	10	33	10

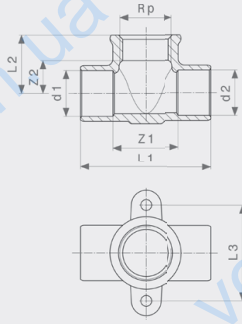

Wall plate T-piece
- gunmetal
Model 94490G

article	d1	Rp	d2	Z1	Z2	L1	L2	L3
118 310	15	1/2	15	30	7	52	22	38
138 127	18	1/2	18	26	8	52	23	38
122 287	22	1/2	22	23	14	56	28	48

MOUNTING UNITS

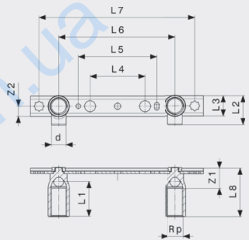

Gemini Mounting unit
Model 94476

article	d	Rp	L	DG	Z1	Z2	L1	L2	L3	L4	L5	L6	L7	L8
107 031	15	1/2	45	150/200	26	13	45	38	26	70	100	150	200	62
111 151	15	1/2	65	150/200	26	13	65	38	26	70	100	150	200	82

DG = depth gauge

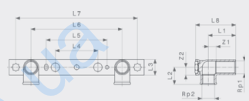

Gemini Mounting unit
Model 94478

article	Rp1	Rp2	L	DG	Z1	Z2	L1	L2	L3	L4	L5	L6	L7	L8
124 892	1/2	1/2	45	150/200	29	13	45	40	26	70	100	150	200	66

DG = depth gauge

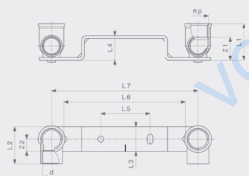

Gemini Mounting unit
Model 94476.0

article	d	Rp	DG	Z1	Z2	L1	L2	L3	L4	L5	L6	L7
123 628	12	1/2	150	17	13	32	34	25	25	50	125	150
101 091	15	1/2	150	20	12	34	36	25	25	50	125	150
108 021	18	1/2	150	22	12	37	38	25	25	50	125	150

DG = depth gauge

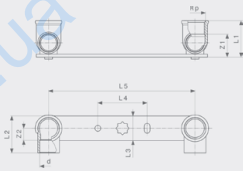

**Gemini Mounting unit
Model 94476.05**

article	d	Rp	DG	Z1	Z2	L1	L2	L3	L4	L5
121 167	12	1/2	150	17	13	32	34	25	50	150
104 986	15	1/2	150	20	12	34	36	25	50	150

DG = depth gauge

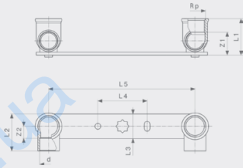

**Gemini Mounting unit
Model 94476.05NOR**

article	d	Rp	DG	Z1	Z2	L1	L2	L3	L4	L5
111 441	12	3/8	150	17	11	28	30	25	50	150
113 988	12	1/2	150							
113 179	15	1/2	150							

DG = depth gauge

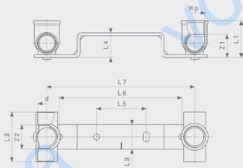

**Gemini Mounting unit
Model 94476.09**

article	d	Rp	DG	Z1	Z2	L1	L2	L3	L4	L5	L6	L7
130 145	15	1/2	150	18	26	34	48	25	25	50	125	150

DG = depth gauge

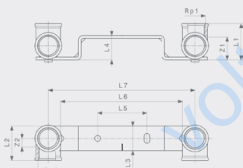

**Gemini Mounting unit
Model 94478.0**

article	Rp1	Rp2	DG	Z1	Z2	L1	L2	L3	L4	L5	L6	L7
118 754	1/2	1/2	150	28	15	44	38	25	25	50	125	150

DG = depth gauge



**Gemini Mounting unit
Model 94476EX**

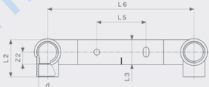

article	d	Rp	DG	Z1	Z2	L1	L2	L3	L4	L5	L6
105 990	12	3/8	150	17	10	28	30	25	21	40	120

DG = depth gauge



**Gemini Mounting unit
Model 94476.1**



article	d	Rp	DG	Z1	Z2	L1	L2	L3	L4	L5	L6
106 119	15	1/2	200	20	12	34	36	25	25	100	200

DG = depth gauge

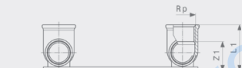

**Gemini Mounting unit
Model 94476.2**

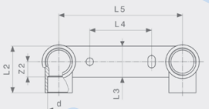

article	d	Rp	DG	Z1	Z2	L1	L2	L3	L4	L5
107 284	15	1/2	100	20	12	34	36	25	55	100

DG = depth gauge



**Gemini Mounting unit
Model 94476.21**

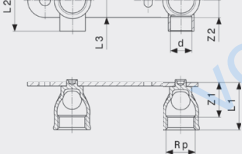

article	d	Rp	DG	Z1	Z2	L1	L2	L3	L4	L5
268 138	15	1/2	80	20	12	34	36	25	80	75

DG = depth gauge

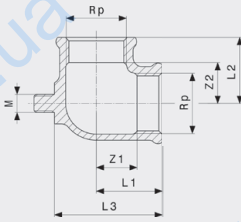

**Connection elbow 90°
Model 94477.0-713**

article	Rp	Z1	Z2	L1	L2	L3	M
374 570¹	½	10	10	25	25	40	8
489 298¹	¾	13	13	29	29	47	8
138 066²	1	15	15	34	34	57	8

M = thread type
¹ gunmetal
² brass

WALL LEAD-INS

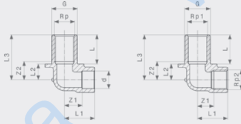

**Wall lead-in
- gunmetal
Model 3426**

article	Rp	d	Rp1	L	Rp2	G	Z1	Z2	L1	L2	L3
333 911¹			½	30	½	¾	16	19	31	16	46
333 928¹	½	15		30		¾	11	15	22	12	42
333 935	½	15		55		¾	11	40	22	12	68
448 936	½	18		30		¾	18	19	31	16	46

¹ for connection in pre-wall cistern

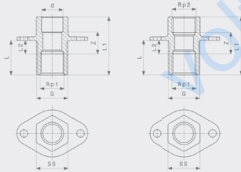

**Wall lead-in
- gunmetal
Model 3427**

article	d	Rp1	L	Rp2	G	Z	L1	L2	SS
333 942		½	30	½	¾	17	50	12	27
333 959	15		30		¾	20	48	12	19

SS = spanner size

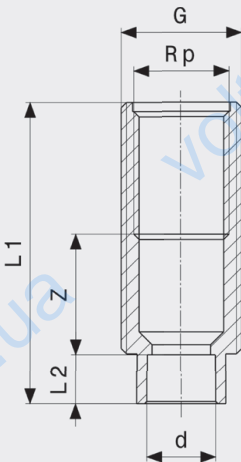

**Wall lead-in
- gunmetal
Model 3427.2**

article	d	L	Rp	G	Z	L1	L2
448 745	15	55	½	¾	25	66	11

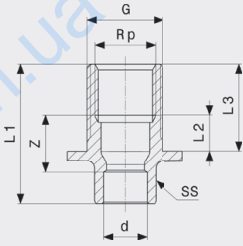

Wall lead-in
- gunmetal
Model 3427.1

article	d	L	Rp	G	Z	L1	L2	L3	SS
448 868	15	30	1/2	3/4	20	48	12	30	19

SS = spanner size



Hexagon nut
- brass
Model 1911

article	G	H	SS
103 347	3/4	6	33

SS = spanner size